

# SLIP ON CLASS 150 WELD FLANGES

MODEL LVWFRF (RAISED FACE)  
MODEL LVWFFF (FLAT FACE)



## DESCRIPTION:

- Material: Carbon Steel
- Complies to ASTM A/105; ANSI B16.5; API-6A; MSS SP-25
- Rated to 270 PSI @ Ambient temp.
- Mill test reports available upon request

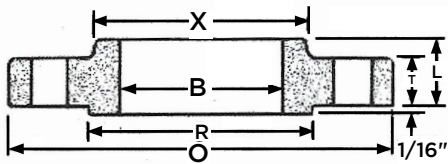

Slip-On-RF  
MODEL LVWFRF

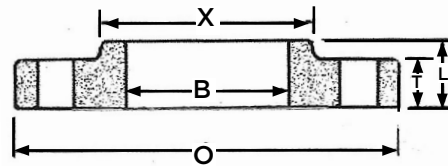

Slip-On-FF  
MODEL LVWFFF

NOMINAL PIPE SIZE (In.)	O (In.)	T (In.)	R (In.)	X (In.)	# DIA OF HOLES (In.)	BOLT CIRCLE DIA. (In.)	B (In.)	L (In.)
2	6.00	0.69	3.62	3.06	4-0.75	4.75	2.44	0.94
2-1/2	7.00	0.81	4.12	3.56	4-0.75	5.50	2.94	1.06
3	7.50	0.88	5.00	4.25	4-0.75	6.00	3.57	1.12
3-1/2	8.50	0.88	5.50	4.81	8-0.75	7.00	4.07	1.19
4	9.00	0.88	6.19	5.31	8-0.75	7.50	4.57	1.25
5	10.00	0.88	7.31	6.44	8-0.88	8.50	5.66	1.38
6	11.00	0.94	8.50	7.56	8-0.88	9.50	6.72	1.50
8	13.50	1.06	10.62	9.69	8-0.88	11.75	8.72	1.69
10	16.00	1.12	12.75	12.00	12-1.00	14.25	10.88	1.88
12	19.00	1.19	15.00	14.38	12-1.00	17.00	12.88	2.12
14	21.00	1.31	16.25	15.75	12-1.12	18.75	14.14	2.19
16	23.50	1.38	18.50	18.00	16-1.12	21.75	16.16	2.44
18	25.00	1.50	21.00	19.88	16-1.25	22.75	18.18	2.62
20	27.50	1.62	23.00	22.00	20-1.25	25.00	20.20	2.81
22	29.50	1.75	25.25	24.25	20-1.38	27.25	22.22	3.07
24	32.00	1.81	27.25	26.12	20-1.38	29.50	24.25	3.19

PROJECT	APPROVAL STAMP
PROJECT:	<input type="checkbox"/> APPROVED
ADDRESS:	<input type="checkbox"/> APPROVED AS NOTED
ENGINEER:	<input type="checkbox"/> NOT APPROVED
SUBMITTAL DATA:	REMARKS:
NOTES 1:	
NOTES 2:	