

# RING HANGER

## MODELS LV-RH & LVRH

### FEATURES:

- Material: Pre-galvanized steel
- Max temp: 450° F
- Knurled swivel nut provides vertical adjustment
- UL/FM Listed and Approved
- Complies with NFPA 13 requirements; ANSI/MSS SP-58-type 10
- Rounded edge design to avoid any abrasion to CPVC piping
- Model LV-RH Listed and Approved for use with Thermoplastic (CPVC) Sprinkler Piping

### MODEL LV-RH



1/2"-1"

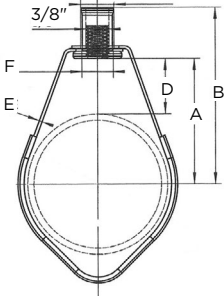

1-1/4"- 2"

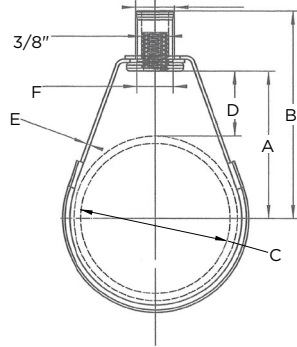

### ADJUSTABLE SWIVEL RING HANGER - CPVC APPROVED

PIPE SIZE (In.)	MAX. LOAD (Lbs.)	WT. (Lbs.)	ROD SIZE (In.)	A (In.)	B (In.)	C (In.)	D (In.)	E (In.)	F (In.)	Width (In.)
1	300	.10	3/8	1.70	2.56	1.40	1.06	0.47	.53	.63
1-1/4	300	.10	3/8	1.75	2.62	1.76	.93	0.47	.53	.63
1-1/2	300	.10	3/8	2.0	1.87	2.0	.93	0.47	.53	.63
2	300	.11	3/8	2.48	2.13	2.52	.93	0.47	.53	.63

### MODEL LVRH

1/2"- 8"

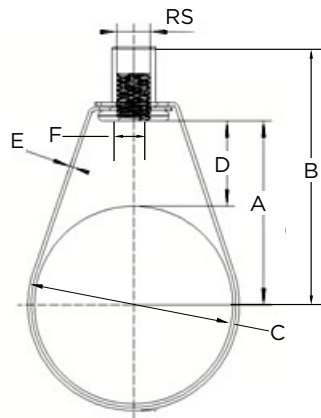

### ADJUSTABLE SWIVEL RING HANGER

PIPE SIZE (In.)	MAX LOAD	WT. (Lbs.)	Rod Size RS	A (In.)	B (In.)	C (In.)	D (In.)	E	F	WIDTH (In.)
1/2-1	300	0.11	3/8	1.65	3.30	1.05	1.0	.047	.51	.63
1-1/4		0.11		1.75	3.55	1.76	.93	.047	.51	
1-1/2		0.11		1.88	3.88	2.0	.93	.047	.51	
2		0.12		2.12	4.25	2.52	.93	.047	.51	
2-1/2	525	0.22	1/2	2.64	5.19	3.05	1.20	.078	.51	.813
3		0.22		2.95	5.69	3.70	1.20	.078	.51	
4	650	0.32		3.45	6.88	4.77	1.20	.098	.51	
5	1,000	0.57		4.25	8.25	5.90	1.50	0.98	.63	
6		0.68		5.00	9.63	7.03	1.70	0.98	.63	
8		1.05		6.75	12.38	9.15	2.45	0.98	.63	

PROJECT		APPROVAL STAMP
PROJECT:		<input type="checkbox"/> APPROVED
ADDRESS:		<input type="checkbox"/> APPROVED AS NOTED
ENGINEER:		<input type="checkbox"/> NOT APPROVED
SUBMITTAL DATA:		REMARKS:
NOTES 1:		
NOTES 2:		