



# NRS RESILIENT SEATED GATE VALVE with GROOVED ENDS & HANDWHEEL

## MODEL LVPIVF-300-H



### DESCRIPTION:

The Lansdale NRS Resilient Seated Gate Valve with Grooved Ends, is used as a control valve for on/off applications.

- Non-rising stem, resilient seated (EDPM encapsulated wedge)
- Available open right, please specify
- Grooved ends to AWWA C606
- NSF/ANSI/CAN 61 certified as lead-free for use in drinking water systems
- Temperature range: 33° F to 170° F
- Fusion bonded epoxy coated interior and exterior to AWWA C550 standard

\*Available with MJ and flanged connections including: MJxMJ; FLxMJ; FLxFL

### INSTALLATION:

Refer to Lansdales' O&M manual for further information and installation instructions.

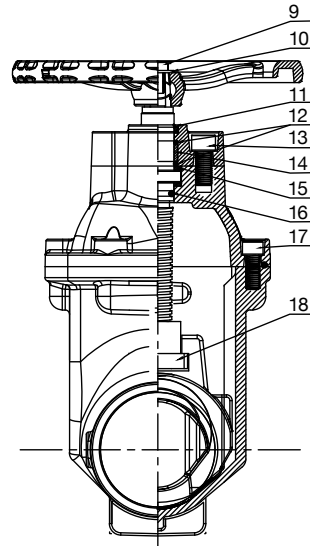
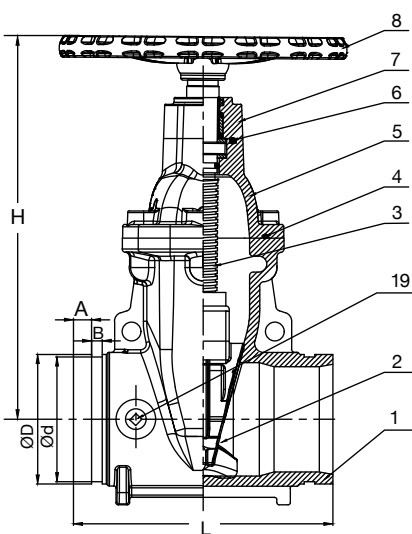

MATERIAL SPECIFICATIONS		
PART NO.	PART	STANDARD. SPEC.
1	Valve Body	ASTM A536-65-45-12
2	Resilient Wedge Disc	ASTM A536-65-45-12+EPDM
3	Stem	SS304
4	Bonnet Gasket	EPDM
5	Bonnet	ASTM A536-65-45-12
6	O-Ring	NBR
7	Gland Flange	ASTM A536-65-45-12
8	Handwheel	ASTM A536-65-45-12
9	Bolt	SS304
10	Flat Washer	SS304
11	Ring Wiper	EPDM
12	O-Ring	NBR
13	Bolt	SS304
14	Axis Guide	C95400
15	Washer	C95400
16	O-Ring	NBR
17	Bolt	SS304
18	Wedge Nut	C95400
19	Plug	C89833

DIMENSIONS						
SIZE (in.)	3	4	6	8	10	12
L (in.)	8.0	9.0	10.51	11.5	13.0	14.0
H (in.)	11.85	14.0	17.64	21.57	24.65	28.43
WT. (lbs.) WITH HANDWHEEL	32.7	47.0	31.0	147.0	229.6	341.0

PROJECT		APPROVAL STAMP
PROJECT:		<input type="checkbox"/> APPROVED
ADDRESS:		<input type="checkbox"/> APPROVED AS NOTED
ENGINEER:		<input type="checkbox"/> NOT APPROVED
SUBMITTAL DATA:		REMARKS:
NOTES 1:		
NOTES 2:		