

Lug Butterfly Valve

Specification

- Meet or exceed the requirements of EN593, AS4795.1 and MSS SP-67
- Replaceable liner for size DN300 and below, Vulcanized liner for size DN350 and above
- 2 shafts for size DN300 and below and 1 shaft for size DN350 and above
- Mounting flange in accordance with ISO 5211 or MSS SP-102
- Connection flanged ends : PN10/16, Class 125 and Table D/E
- WRAS approved

Working Pressure and Temperature

- 16 bar / 250 psi rated at -10°C to 120°C for EPDM liner
- 16 bar / 250 psi rated at -10°C to 87°C for BUNA-N liner

Corrosion Protection

- Fusion bonded coating or liquid painting interior and exterior

Options

- PN25 available
- Ductile Iron body
- SS304 / 316 stainless steel shaft
- GX5CrNiMo19-11-2 (1.4408) disc for #2502
- Gear operator or handle operated
- Built-in temper switch of gear operator

Material Specification

Part	Material	EN Specification	ASTM Specification
Body	Cast Iron	EN1561, EN-GJL-250	A126 Class B
Shaft	Stainless Steel	EN10088, X20Cr13	A276, Grade 420
Disc	Stainless Steel	EN10213, GX5CrNi19-10	A351 CF8
	Bronze	EN1982, CC491K	B62 C83600
	Ductile Iron	EN1563, EN-GJS-450-10	A536 65-45-12
Liner	Rubber	EN681, EPDM or NBR	D2000
Bushing	Plastic	Commercial, PTFE	Commercial, PTFE
Shaft Sealing	O-Ring	EN681, BUNA-N	D2000 NBR

Dimensions (mm)

Size	DN50	DN65	DN80	DN100	DN125	DN150	DN200	DN250	DN300	DN350	DN400	DN450	DN500	DN600
A	140	155	160	180	190	205	240	275	315	370	400	425	480	565
B	70	80	85	100	120	135	165	200	230	290	315	340	390	450
E	43	46	46	52	56	56	60	68	78	78	88	109	127	154
Shaft Top Section	11 x 11			14 x 14		17 x 17		22 x 22			27 x 27		Dia. 48	
Mounting Flange	F07						F10		F12	F14		F16		
C	30						45							

Notes

- Designs, materials and specifications shown are subject to change without notice due to the continuous development of our products.

FIG. LV2502 - Stainless Steel Disc
FIG. LV2503 - Bronze Disc
FIG. LV2504 - Ductile Iron Disc

Schematic

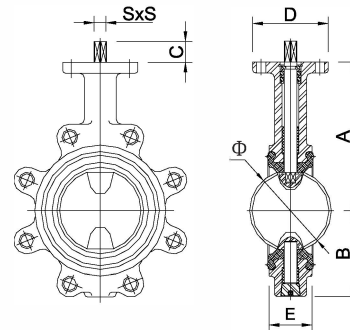
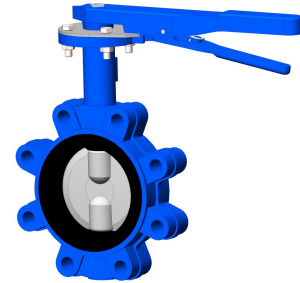

Size 50-300

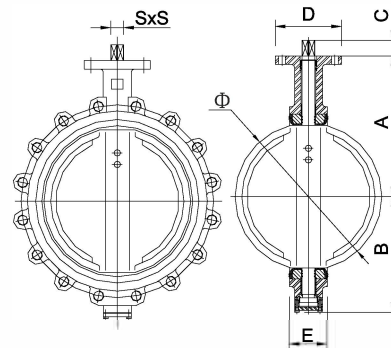

Size 350-600